

BUILDING SECTION

SCALE: 3/8" = 1'-0"

C

A1/A3

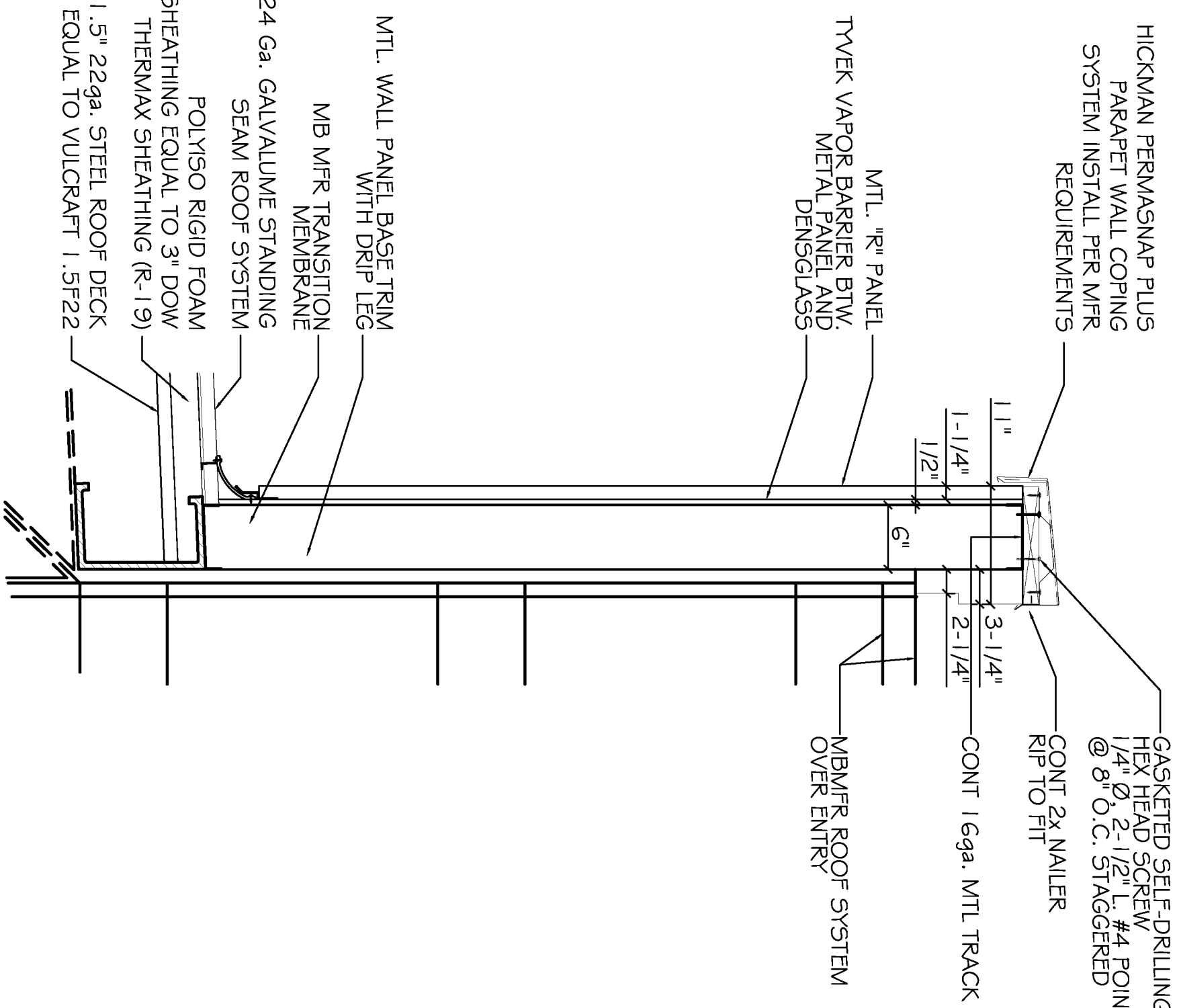

PARAPET COPING DETAIL

SCALE: 1" = 1'

DOOR & HARDWARE SCHEDULE

MARK	SIZE	DOOR TYPE	FRAME	HDWR. NO.	STC	REMARKS
EXTERIOR DOORS						
1	PR. 3/0x7/0	STORE FRONT	TO MATCH DOOR	1	NA	STOREFRONT UNIT. PROVIDE TRANSOM. SEE ELEVATIONS
2	3/0x7/0	STORE FRONT	TO MATCH DOOR	1	NA	STOREFRONT UNIT. PROVIDE TRANSOM. SEE ELEVATIONS
3	3/0x6/8	FLUSH GALV. HOL. MET. STEEL INSUL.	GALV. PTD. HOL. MET.	1	NA	GALVANIZING TO BE G90

INTERIOR DOORS						
4	PR. 3/0x7/0	STORE FRONT	TO MATCH DOOR	2	NA	STOREFRONT UNIT TO MATCH INTERIOR WALL SYSTEM
5	3/0x7/0	STORE FRONT	TO MATCH DOOR	2	NA	STOREFRONT UNIT TO MATCH INTERIOR WINDOW WALL SYSTEM
6	3/0x6/8	FLUSH SOLID CORE WD.	PTD. HOL. MET.	4	NA	STAIN SELECT BY OWNER
7	PR. 3/0x6/8	FLUSH SOLID CORE WD.	PTD. HOL. MET.	4	NA	STAIN SELECT BY OWNER
8	PR. 3/0x6/8	FLUSH SOLID CORE WD.	PTD. HOL. MET.	3	NA	STAIN SELECT BY OWNER
9	3/0x6/8	FLUSH SOLID CORE WD.	PTD. HOL. MET.	3	NA	STAIN SELECT BY OWNER
10	3/0x6/8	FLUSH SOLID CORE WD.	PTD. HOL. MET.	5	NA	STAIN SELECT BY OWNER
11	3/6x7/0	CASED OPENING	NA	NA	NA	

DOOR HARDWARE SCHEDULE:

1. AUTO CLOSER, PAINC BAR, AIR RESISTING METAL THRESHOLD, WEATHERSTRIP, DOOR STOP, EXTERIOR CYLINDER LOCK (OFFICENATNAC), BALL BEARING US32D HINGES.

2. AUTO CLOSER, DOOR STOP, CYLINDER LOCK (OFFICENATNAC), BALL BEARING US32D HINGES.

3. PASSEGE LOCK, DOOR STOP, US32D HINGES.

4. AUTO CLOSER (OFFICENATNAC), DOOR STOP, US32D HINGES.

5. AUTO CLOSER, DOOR STOP, PASSEGE LOCK, BALL BEARING US32D HINGES.

WINDOW SCHEDULE

MARK	SIZE	WINDOW TYPE	FRAME	GLASS	LTES	REMARKS
A	OVERALL UNIT SIZE VARIES, SEE PLAN NOM. FANE 4x1'0"	ALUMINUM STOREFRONT	ALUMINUM 2' x 6'	LOW E		SEE EXTERIOR ELEVATIONS
B	OVERALL UNIT SIZE = 4'-4" NOM. FANE 4x4'	ALUMINUM STOREFRONT	ALUMINUM 2' x 6'	1/4" CLEAR TEMPERED		INTERIOR WINDOW
C	OVERALL UNIT SIZE = 1'4" NOM. FANE 3'-3x1'0"	ALUMINUM STOREFRONT	ALUMINUM 2' x 6'	LOW E		SEE EXTERIOR ELEVATIONS
D	OVERALL UNIT SIZE VARIES, SEE PLAN NOM. FANE 4'-1'x4'	ALUMINUM STOREFRONT	ALUMINUM 2' x 4'-1/2"	1/4" CLEAR TEMPERED		INTERIOR WINDOW
E	OVERALL UNIT SIZE VARIES, SEE PLAN NOM. FANE 3x4'	ALUMINUM STOREFRONT	ALUMINUM 2' x 4'-1/2"	1/4" CLEAR TEMPERED		INTERIOR WINDOW
F	2' x 4'	HOLLOW METAL FIXED	HOLLOW METAL	LOW E		
G	PR. SERVICE WINDOW SIZE = 5'-0"x4'-0"	ALUMINUM HORZ. SLIDE SERVICE WINDOW	ALUMINUM 2' x 4'-1/2"	1/4" CLEAR TEMPERED		
H	SERVICE WINDOW SIZE = 4'-2'x4'	ALUMINUM HORZ. SLIDE SERVICE WINDOW	ALUMINUM 2' x 4'-1/2"	LOW E		
I	2' x 3'	HOLLOW METAL FIXED	HOLLOW METAL	1/4" CLEAR TEMPERED		ONE-WAY SECURITY WINDOW

WINDOW SCHEDULE NOTES:

I. GLAZING TO BE DBL. GLAZED LAMINATED LOW E.

FINISH SCHEDULE

ROOM NUMBER	ROOM NAME	WALLS	EXTEND WALL TO ROOF DECK	FLOOR	WALL BASE	WAINSCOT	CLG HGT	COMMENTS
100	MAIN FLOOR	5/8" PTD GWB						
101	SMOOTHIE STORE							
102	WARMING KITCHEN							
103	MENS TOILET							
104	WOMENS TOILET							
105	TRAINERS CHOICE							
106	TREADMILL AREA							
107	MENS TOILET							
108	SHOWER 1							
109	SHOWER 2							
110	SHOWER 3							
111	WOMENS TOILET							
112	CLOSET							
113	OFFICE							
114	ELEC / IT							
115	CARDIO							
116	CHILD CARE							
117	WOMENS TOILET							
118	MENS TOILET							
119	OFFICE							
120	OFFICE							
121	PHYSICAL THERAPY							

LEGEND:

GWB GYPSUM WALL BOARD

CT CEILING TILE, 2'x4'

RB RUBBER BASE 4" HIGH

WB WOOD BASE

VCT VINYL COMPOSITION TILE

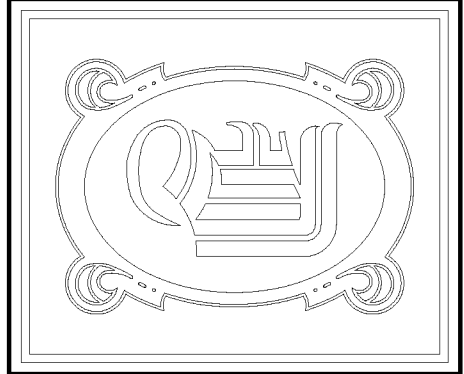

DAMMON
ENGINEERING, INC.

CHIEF ENGINEER
ENAMETT
DAMMON, P.E.

CHIEF ARCHITECT
ROBERT
WILTSE

554 OLD SPANISH TRAIL
SUITE 11, 70456
OFFICE: 985-649-5632
FAX: 985-641-5950

WEBSITE:
WWW.DAMMONENGINEERING.COM
EMAIL:
DAMMONENG@BELL.SOUTH.NET

ARCHITECTURE
ENGINEERING
STUDIES
PLANNING
INVESTIGATION
EXPERT WITNESS